

| Boom pole profile | Pole length | Number of springs required | Spring part number |
|---------------------------------------|-------------|----------------------------|--------------------|
| 76.2 x 1.27 Aluminium tube = 0.81kg/m | 3m | 1 (white) | 1094100100 |
| 76.2 x 1.27 Aluminium tube = 0.81kg/m | 4.5m | 1 (red) | 1094100200 |
| 76.2 x 1.27 Aluminium tube = 0.81kg/m | 6m | 1 (black) | 1094100300 |
| 76.2 x 1.8 Aluminium tube = 1kg/m | 3m | 1 (red) | 1094100200 |
| 76.2 x 1.8 Aluminium tube = 1kg/m | 4.5m | 1 (black) | 1094100300 |
| 76.2 x 1.8 Aluminium tube = 1kg/m | 6m | 2* (black) | 1094100300 |
| 80 x 1.5 Aluminum tube = 1kg/m | 3m | 1 (red) | 1094100200 |
| 80 x 1.5 Aluminum tube = 1kg/m | 4.5m | 1 (black) | 1094100300 |
| 80 x 1.5 Aluminum tube = 1kg/m | 6m | 2* (black) | 1094100300 |

* See page 3 for installation procedure

Centinel Boom Assembly

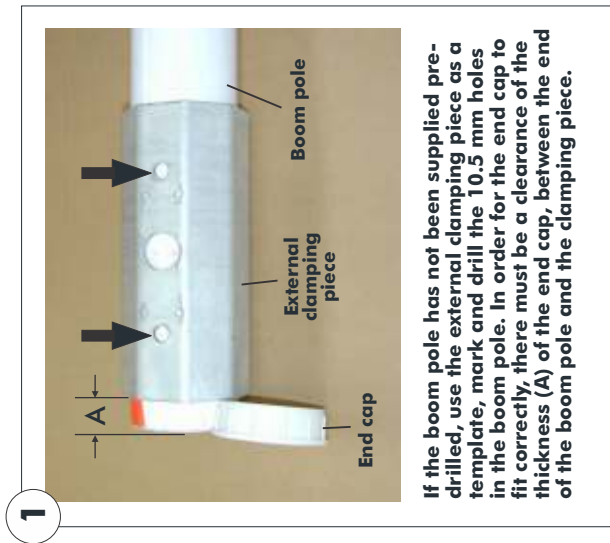
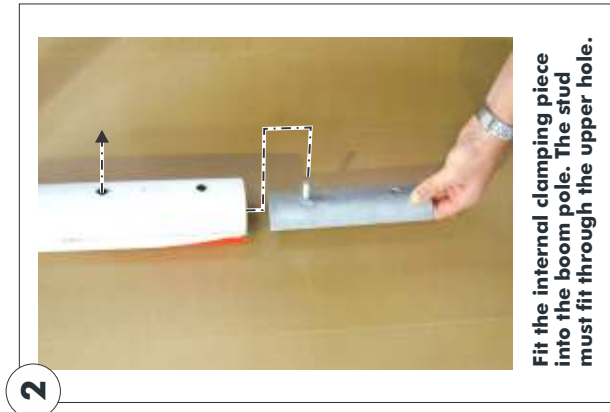

Fitting a dual spring to a 6m Centinel manual boom assembly for poles that weigh +/- 1kg/m

The standard South African round boom pole weighs 0,8kg/m and does not require the dual spring with the 6m model.



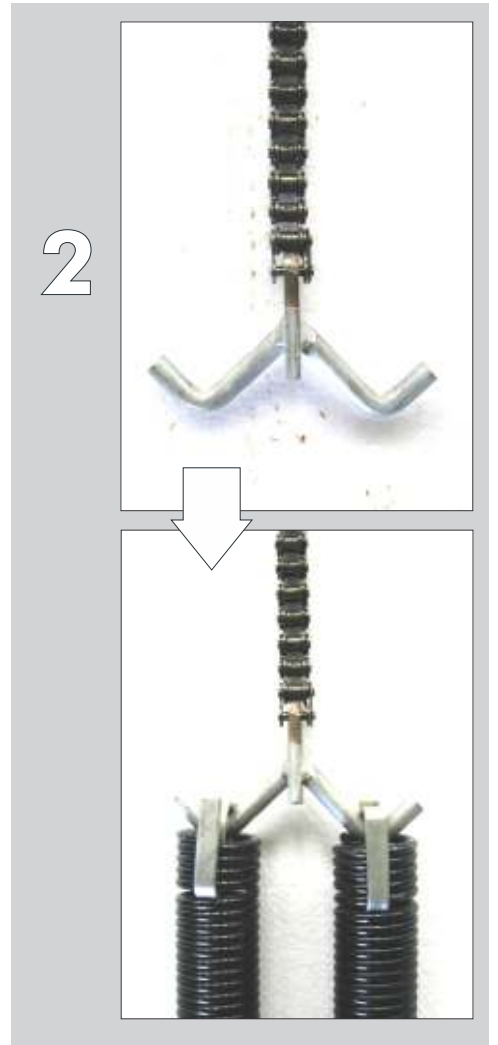
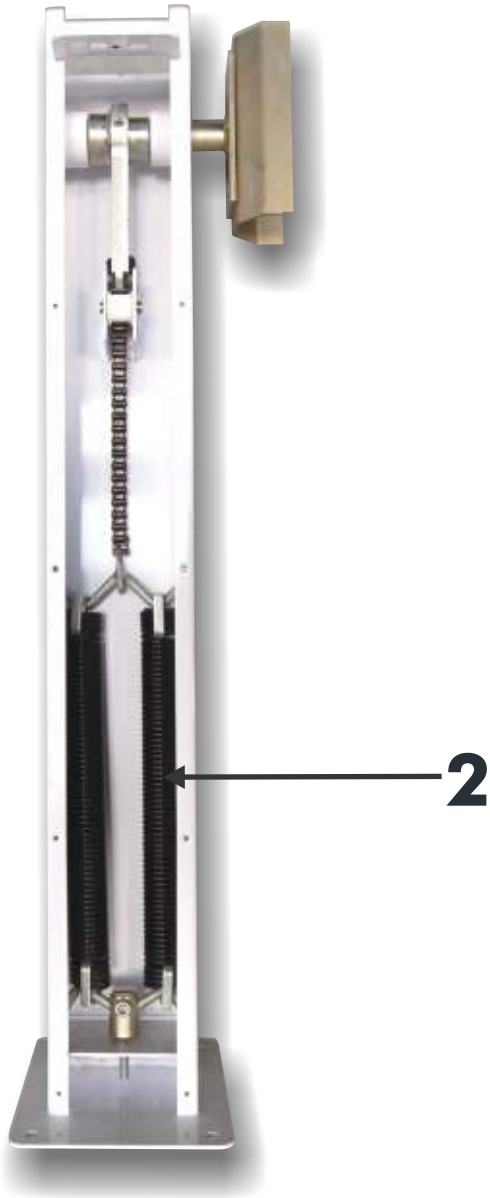

0.07.A.0164_22072013

www.centsys.com