

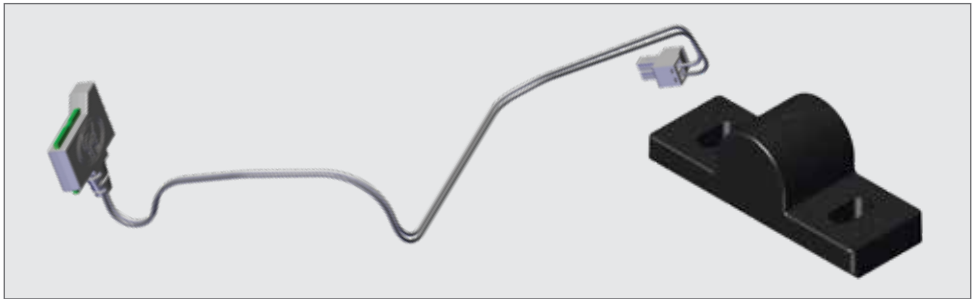

SMART ORIGIN SENSOR AND MARKER QUICK GUIDE



1. Connecting the Origin Sensor

Place the Origin Sensor into its dedicated slot found just above the Pinion on the Lower Battery Tray.

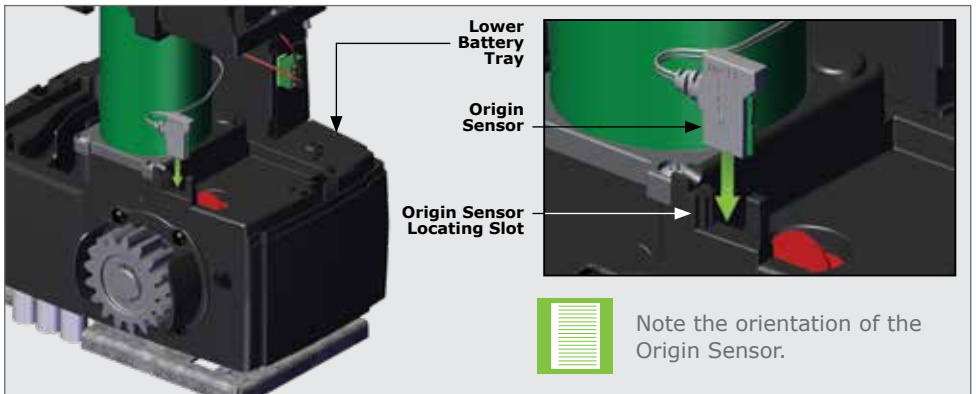

FIGURE 1

Route the Harness around the electric motor to the front of the **SMART Gate Motor**, and through the cable retainers found in front of the Control Card.

Connect the Harness to the white "Origin" Terminal found on the Control Card.

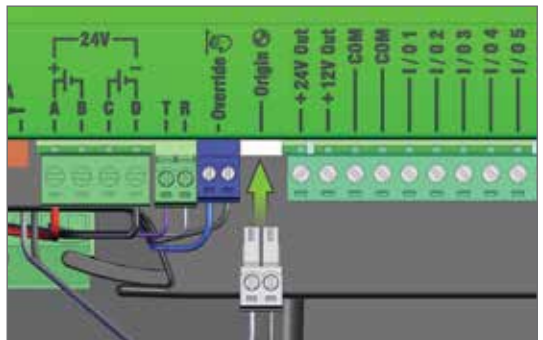

FIGURE 2

2. Mounting the Origin Marker

Firstly, close the gate completely.

Mount the Origin Marker to the rack a minimum of 500mm from the Origin Sensor. Refer to Figure 3.



It is possible to make the distance between the Marker and the Sensor much greater than 500mm. However, if using the pedestrian opening facility, although the position of the Marker will not affect the width of the pedestrian opening, it is preferable to have the Marker mounted inside of the pedestrian opening point. This ensures that the system remains synchronised / calibrated.

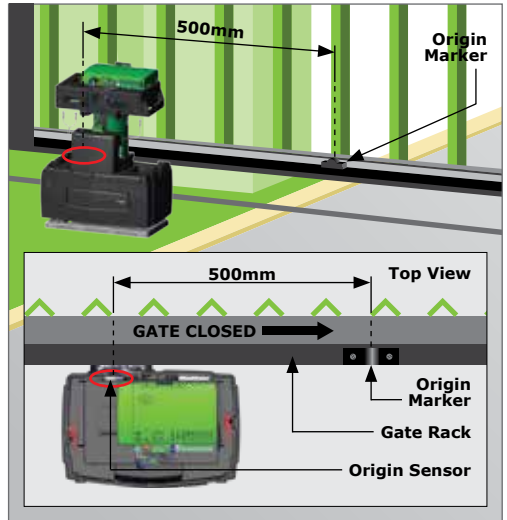

FIGURE 3

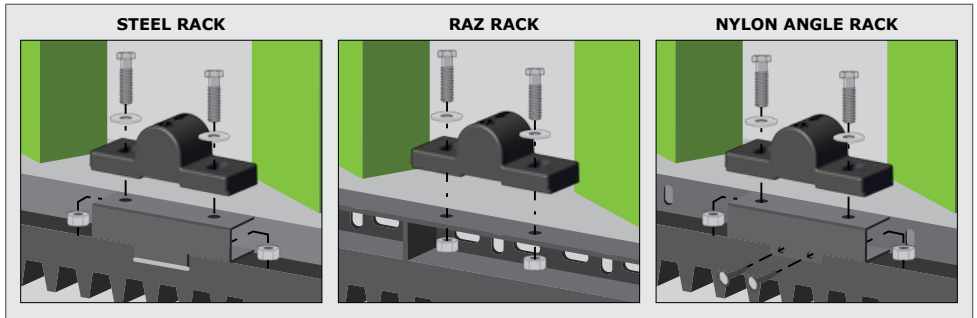

FIGURE 4

Note the orientation of the Origin Marker in Figures 4 and 5.

Manually slide the gate open until the Origin Marker is in line with the Origin Sensor.

Ensure the distance between the face of the Marker and front face of the Sensor is between 10 and 20mm.

Adjust distance by sliding the Origin Marker along the slotted mounting holes until the specified distance is achieved.

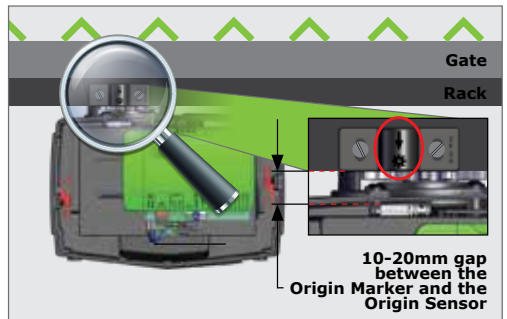

FIGURE 5

In order to set up the Origin functionality, run the Limits setup in the MyCentsys Pro application.



MADE IN
SOUTH AFRICA



Doc number: 1401.D.01.0008_2
SAP Code: DOC1401D0108